

CAM & GROOVE FITTINGS

“A”

**MALE ADAPTER x
FEMALE THREAD**



	<u>ALUMINUM</u>	<u>POLY PRO</u>	<u>STAINLESS STEEL</u>
3/4"	#ACGA7	#PCGA7	#SCGA7
1"	#ACGA10	#PCGA10	#SCGA10
1-1/4"	#ACGA12	#PCGA12	#SCGA12
1-1/2"	#ACGA15	#PCGA15	#SCGA15
2"	#ACGA20	#PCGA20	#SCGA20
3"	#ACGA30	#PCGA30	#SCGA30
4"	#ACGA40	—	*
6"	#ACGA60	—	*

“F”

**MALE ADAPTER x
MALE THREAD**



	<u>ALUMINUM</u>	<u>POLY PRO</u>	<u>STAINLESS STEEL</u>
3/4"	#ACGF7	#PCGF7	#SCGF7
1"	#ACGF10	#PCGF10	#SCGF10
1-1/4"	#ACGF12	#PCGF12	#SCGF12
1-1/2"	#ACGF15	#PCGF15	#SCGF15
2"	#ACGF20	#PCGF20	#SCGF20
3"	#ACGF30	#PCGF30	#SCGF30
4"	#ACGF40	—	*
6"	#ACGF60	—	*

**CAM & GROOVE
GASKET ONLY**



3/4"	#CGGO7	2"	#CGGO20
1"	#CGGO10	3"	#CGGO30
1-1/4"	#CGGO12	4"	#CGGO40
1-1/2"	#CGGO15	6"	#CGGO60



“D”

**FEMALE COUPLER
x FEMALE THREAD**



	<u>ALUMINUM</u>	<u>POLY PRO</u>	<u>STAINLESS STEEL</u>
3/4"	#ACGD7	#PCGD7	#SCGD7
1"	#ACGD10	#PCGD10	#SCGD10
1-1/4"	#ACGD12	#PCGD12	#SCGD12
1-1/2"	#ACGD15	#PCGD15	#SCGD15
2"	#ACGD20	#PCGD20	#SCGD20
3"	#ACGD30	#PCGD30	#SCGD30
4"	#ACGD40	—	*
6"	#ACGD60	—	*

“B”

**FEMALE COUPLER
x MALE THREAD**



	<u>ALUMINUM</u>	<u>POLY PRO</u>	<u>STAINLESS STEEL</u>
3/4"	#ACGB7	#PCGB7	#SCGB7
1"	#ACGB10	#PCGB10	#SCGB10
1-1/4"	#ACGB12	#PCGB12	#SCGB12
1-1/2"	#ACGB15	#PCGB15	#SCGB15
2"	#ACGB20	#PCGB20	#SCGB20
3"	#ACGB30	#PCGB30	#SCGB30
4"	#ACGB40	—	*
6"	#ACGB60	—	*

* = AVAILABLE

**** WEBSITE ****



www.dixonvalve.com



‘E’

MALE ADAPTER x
HOSE BARB



	<u>ALUMINUM</u>	<u>POLY PRO</u>	<u>STAINLESS STEEL</u>
3/4"	#ACGE7	#PCGE7	#SCGE7
1"	#ACGE10	#PCGE10	#SCGE10
1-1/4"	#ACGE12	#PCGE12	#SCGE12
1-1/2"	#ACGE15	#PCGE15	#SCGE15
2"	#ACGE20	#PCGE20	#SCGE20
3"	#ACGE30	#PCGE30	#SCGE30
4"	#ACGE40	—	*
6"	#ACGE60	—	*

CAM & GROOVE
PLUG



	<u>ALUMINUM</u>	<u>POLY PRO</u>	<u>STAINLESS STEEL</u>
3/4"	#ACGP7	#PCGP7	#SCGP7
1"	#ACGP10	#PCGP10	#SCGP10
1-1/4"	#ACGP12	#PCGP12	#SCGP12
1-1/2"	#ACGP15	#PCGP15	#SCGP15
2"	#ACGP20	#PCGP20	#SCGP20
3"	#ACGP30	#PCGP30	#SCGP30
4"	#ACGP40	—	*
6"	#ACGP60	—	*

CAN'T FIND IT?

GIVE US A CALL.

(714) 241-7050



CAM & GROOVE FITTINGS



‘C’

FEMALE COUPLER
x HOSE BARB

	<u>ALUMINUM</u>	<u>POLY PRO</u>	<u>STAINLESS STEEL</u>
3/4"	#ACGC7	#PCGC7	#SCGC7
1"	#ACGC10	#PCGC10	#SCGC10
1-1/4"	#ACGC12	#PCGC12	#SCGC12
1-1/2"	#ACGC15	#PCGC15	#SCGC15
2"	#ACGC20	#PCGC20	#SCGC20
3"	#ACGC30	#PCGC30	#SCGC30
4"	#ACGC40	—	*
6"	#ACGC60	—	*



CAM & GROOVE
CAP

	<u>ALUMINUM</u>	<u>POLY PRO</u>	<u>STAINLESS STEEL</u>
3/4"	#ACGCA7	#PCGCA7	#SCGCA7
1"	#ACGCA10	#PCGCA10	#SCGCA10
1-1/4"	#ACGCA12	#PCGCA12	#SCGCA12
1-1/2"	#ACGCA15	#PCGCA15	#SCGCA15
2"	#ACGCA20	#PCGCA20	#SCGCA20
3"	#ACGCA30	#PCGCA30	#SCGCA30
4"	#ACGCA40	—	*
6"	#ACGCA60	—	*

We gladly accept...



**AIR KING
UNIVERSAL COUPLINGS**

MALLEABLE IRON

**MALE
ENDS**



1/4"	#AMB1
3/8"	#AMB
1/2"	#AM2
3/4"	#AM7
1"	#AM12

**FEMALE
ENDS**



1/4"	#AMC1
3/8"	#AMC
1/2"	#AM3
3/4"	#AM8
1"	#AM13

**HOSE
ENDS**



3/8"	#AMH
1/2"	#AM1
5/8"	#AM5
3/4"	#AM6
1"	#AM11

**AIR KING
GASKET
ONLY**

#AWR4



'KING' HOSE NIPPLE



**PLATED
STEEL**

BARB x MALE

1/2"	#GKN5
3/4"	#GKN7
1"	#GKN10
1-1/4"	#GKN12
1-1/2"	#GKN15
2"	#GKN20
2-1/2"	#GKN25
3"	#GKN30
4"	#GKN40
6"	#GKN60

BRASS:

- SEE PAGE 62

STAINLESS STEEL:

- SEE PAGE 67

PLASTIC:

- SEE PAGE 108

ALUMINUM:

- AVAILABLE

**BARB x BARB
HOSE MENDER COUPLING**



**PLATED
STEEL**

1/2"	#GBB5
3/4"	#GBB7
1"	#GBB10
1-1/4"	#GBB12
1-1/2"	#GBB15
2"	#GBB20
2-1/2"	#GBB25
3"	#GBB30
4"	#GBB40

**HOSE CLAMP,
WORM GEAR**



ALL STAINLESS BAND & NUT

MINI: (5/16" WIDE)

<u>MIN</u>	<u>MAX</u>	<u>HOSE I.D.</u>	
1/4"	5/8"	1/4"	#HC4M
1/2"	3/4"	3/8"	#HC6M

STANDARD: (1/2" WIDE)

<u>MIN</u>	<u>MAX</u>	<u>HOSE I.D.</u>	
1/2"	3/4"		#HC6
1/2"	7/8"	1/2"	#HC8
5/8"	1"	5/8"	#HC10
3/4"	1-1/4"	3/4"	#HC12
7/8"	1-1/2"	1"	#HC16
7/8"	1-3/4"	1-1/4"	#HC20
1-1/8"	2"		#HC24
1-3/8"	2-1/4"	1-1/2"	#HC28
1-1/2"	2-1/2"		#HC32
1-7/8"	2-3/4"		#HC36
2"	3"	2"	#HC40
2-3/8"	3-1/4"		#HC44
2-1/2"	3-1/2"	2-1/2"	#HC48
2-7/8"	3-3/4"	3"	#HC52
3"	4"		#HC56
3-3/8"	4-1/4"		#HC60
3-1/2"	4-1/2"		#HC64
4-1/8"	5"	4"	#HC72
4-5/8"	5-1/2"		#HC80
5-1/8"	6"		#HC88
5-1/2"	6-1/2"		#HC96
6-1/8"	7"	6"	#HC104

NUT DRIVER



FOR HOSE CLAMPS

5/16" #NUTD516

HOSE BAND CLAMP



HOSE

I.D.

1"	#FS4
1-1/4"	#FS5
1-1/2"	#FS6
2"	#FS8
2-1/2"	#FS10
3"	#FS12
4"	#FS16

OTHER SIZES AVAILABLE

BAND CLAMP TOOL



#F1

TUBE & HOSE CUTTERS



TUBE/
HOSE O.D.

3/4"	#TC97
1-1/4"	#73003
1-7/8"	#LHC95

**QUESTIONS?
GIVE US A CALL**

(714) 241-7050



**R.V.T. TUBING
(REINFORCED VINYL)**



GOOD TO 150°F
FDA & NSF APPROVED

AVAILABLE LENGTHS:
10', 20', 40', 60', 80' & 100'

HOSE	W.P.@	
<u>I.D.</u>	<u>70°F</u>	
1/4"	250#	#RVT2
3/8"	225#	#RVT3
1/2"	200#	#RVT5
5/8"	200#	#RVT58
3/4"	150#	#RVT7
1"	125#	#RVT10
1-1/4"	100#	#RVT12
1-1/2"	100#	#RVT15
2"	75#	#RVT20

**C.V.T. TUBING
(CLEAR VINYL)**



GOOD TO 150°F
FDA & NSF APPROVED

AVAILABLE LENGTHS:
10', 20', 40', 60', 80' & 100'

HOSE	W.P.@	
<u>I.D.</u>	<u>70°F</u>	
1/4"	65#	#CVT2
5/16"	55#	#CVT516
3/8"	55#	#CVT3
7/16"	50#	#CVT716
1/2"	45#	#CVT5
3/4"	30#	#CVT7
1"	35#	#CVT10

**POLY-FLO TUBING
(POLYETHYLENE)**



GOOD TO 140°F

AVAILABLE LENGTHS:
10', 20', 40', 60', 80' & 100'

(LONGER LENGTHS AVAILABLE)

NATURAL COLOR:
(WHITE)

TUBE	W.P.@	
<u>O.D.</u>	<u>70°F</u>	
1/8"	125#	#PFT1
1/4"	140#	#PFT2
3/8"	125#	#PFT3
1/2"	100#	#PFT5
5/8"	75#	#PFT58

BLACK:

TUBE	W.P.@	
<u>O.D.</u>	<u>70°F</u>	
1/4"	140#	#PFTB2
3/8"	125#	#PFTB3
1/2"	100#	#PFTB5

TEFLON TUBING



PTFE
GOOD TO 500°F

AVAILABLE LENGTHS:
10', 20', 40', 60', 80' & 100'

TUBE	W.P.@	
<u>O.D.</u>	<u>70°F</u>	
1/4"	210#	#TET2
3/8"	180#	#TET3
1/2"	130#	#TET5

**AIR & WATER HOSE
RED**



GOOD TO 190°F

AVAILABLE LENGTHS:

1/4" - 1"
10', 20', 40', 60', 80' & 100'

1-1/4" - 2"
10', 20', 40' & 60'

HOSE I.D.	PRESS. RATING	
1/4"	250#	#AWH2
3/8"	250#	#AWH3
1/2"	250#	#AWH5
3/4"	250#	#AWH7
1"	300#	#AWH10
1-1/4"	200#	#AWH12
1-1/2"	200#	#AWH15
2"	200#	#AWH20

MANY OTHER HOSES AVAILABLE. CALL WITH YOUR REQUIREMENTS

**LAY FLAT DISCHARGE
HOSE, BLUE**



AVAILABLE LENGTHS:
1-1/2" & 2" - 25', 50' & 100'
3" & 4" - 25' & 50'

HOSE I.D.	
1-1/2"	#LFH15
2"	#LFH20
3"	#LFH30
4"	#LFH40

VACUUM/SUCTION HOSE

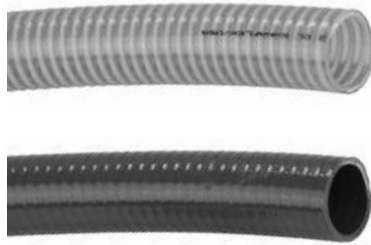

GOOD TO 150°F
28" HG VACUUM RATING @ 68°F

AVAILABLE LENGTHS:
10', 20', 40', 60', 80' & 100'

CLEAR:

HOSE I.D.	W.P.@ 68°F	
3/4"	110#	#STH7
1"	85#	#STH10
1-1/4"	85#	#STH12
1-1/2"	70#	#STH15
2"	65#	#STH20
2-1/2"	65#	#STH25
3"	60#	#STH30
4"	50#	#STH40

GREEN:

HOSE I.D.	W.P.@ 68°F	
3/4"	110#	#STHG7
1"	85#	#STHG10
1-1/4"	85#	#STHG12
1-1/2"	70#	#STHG15
2"	65#	#STHG20
3"	60#	#STHG30
4"	50#	#STHG40

**HOSE REEL
(REELCRAFT)**



SEE PAGE 124

BLOWER/EXHAUST HOSE



GOOD TO 150°F
FLEXIBLE HOSE FOR LOW PRESSURE APPLICATIONS.

SOLD IN 10' INCREMENTS

HOSE I.D.	W.P.@ 68°F	
1-1/2"	20#	#BEH15
2"	15#	#BEH20
2-1/2"	10#	#BEH25
3"	10#	#BEH30
4"	8#	#BEH40

PVC SPA-FLEX HOSE



SOLD IN 10' INCREMENTS

HOSE SIZE	
1"	#SFH10
1-1/4"	#SFH12
1-1/2"	#SFH15
2"	#SFH20

GLUES TO PVC SCH. 40 FITTINGS WITH PVC CEMENT

DISHWASHER HOSE



SOLD IN 5' INCREMENTS

5/8" I.D.	#506
7/8" I.D.	#507

BRASS FIRE HYDRANT FITTINGS



NST = FIRE HOSE THREAD
 GHT = GARDEN HOSE THREAD
 MIP = MALE PIPE THREAD
 FIP = FEMALE PIPE THREAD

<u>FEMALE</u>		<u>MALE</u>		
1-1/2" NST	x	3/4" GHT		#HA-1576
2-1/2" NST	x	3/4" GHT		#HA-2576
<hr/>				
2-1/2" NST	x	1-1/2" NST		#HA-2515F
1-1/2" NST	x	1-1/2" MIP		#FM-15F15T
2-1/2" NST	x	1-1/2" MIP		#HA-2515T
2-1/2" NST	x	2" MIP		#HA-2520T
2-1/2" NST	x	2-1/2" MIP		#FM-25F25T

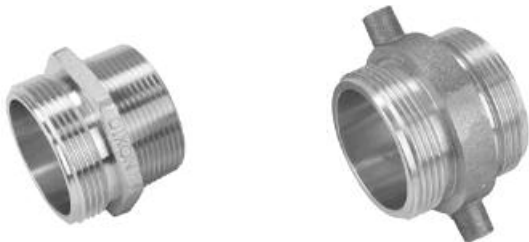

<u>MALE</u>		<u>MALE</u>		
1-1/2" NST	x	1-1/2" MIP		#DMH-1515F
2-1/2" NST	x	2" MIP		#DMH-2025F
2-1/2" NST	x	2-1/2" MIP		#DMH-2525F
<hr/>				
1-1/2" NST	x	1-1/2" NST		#DMP-1515F
2-1/2" NST	x	2-1/2" NST		#DMP-2525F

FIRE HYDRANT WRENCHES

ADJUSTABLE
#AHW



FIVE HOLE
#PHW



BRASS FIRE HYDRANT FITTINGS



**SWIVEL
FEMALE x MALE**

<u>FEMALE</u>		<u>MALE</u>		
1-1/2" NST	x	1-1/2" MIP		#SM-150F
2-1/2" NST	x	2-1/2" MIP		#SM-250F



**SWIVEL
FEMALE x FEMALE**

<u>FEMALE</u>		<u>FEMALE</u>		
1-1/2" NST	x	1-1/2" NST		#DFP-1515F
2-1/2" NST	x	2-1/2" NST		#DFP-2525F
<hr/>				
2-1/2" NST	x	2-1/2" FIP		#SF-250F



**CAP
WITH CHAIN**

<u>FEMALE</u>			
1-1/2" NST BRASS			#FC-150F
2-1/2" NST BRASS			#FC-250F
<hr/>			
2-1/2" NST PLASTIC (RED)			#PFCW-250F
2-1/2" BREAKABLE CAP			#PBC-250



**PLUG
WITH CHAIN**

<u>MALE</u>			
2-1/2" NST BRASS			#FP-250F

FIRE HOSE



300#
NST MALE x FEMALE ENDS
1-1/2" x 50' #A315-50RAF
1-1/2" x 100' #A315-100RAF

**FOG NOZZLE
THERMOPLASTIC**



FEMALE INLET
3/4" GARDEN HOSE THREAD
#FNB-75GHT
1-1/2" NST FIRE HOSE THREAD
#FNB-150NST
1-1/2" FEMALE PIPE THREAD
#FNB-150S

**BRASS FIRE HOSE
VALVE**



ANGLE

UL & FM APPROVED

FEMALE PIPE INLET
1-1/2"
2-1/2"
MALE FIRE HOSE OUTLET
1-1/2" #AV-150
2-1/2" #AV-250

FIRE SPRINKLER HEADS



PENDANT
165° F

1/2" MALE #FSA2



UPRIGHT
165° F

1/2" MALE #FSA3



SIDEWALL
165° F

1/2" MALE #FSA4

SPRINKLER HEAD CANOPY



CHROME PLATED

ADJUSTABLE 2" - 3"
#FSA7

SPRINKLER HEAD GUARD



RED
#FSA10

SPRINKLER HEAD WRENCH



#FSA12

STORAGE BIN

CARDBOARD



HELPS ORGANIZE PARTS

SEE PAGE 220



**QUESTIONS?
GIVE US A CALL**

(714) 241-7050

RECOIL AIR HOSE



200# PSI
YELLOW-NYLON
360° BRASS SWIVEL ENDS

- 1/4" x 12' #AMF412
- 1/4" x 17' #AMF415
- 1/4" x 25' #AMF425
- 3/8" x 17' #AMF615
- 3/8" x 25' #AMF625
- 1/2" x 25' #AMF825

AIR HOSE ASSEMBLY



300# PSI
SWIVEL ENDS

- 1/4" x 25' #AHA225
- 1/4" x 50' #AHA250

OTHER SIZES AVAILABLE

AIR MUFFLER



MALE

- 1/8" #MS001A
- 1/4" #MS002A
- 3/8" #MS003A
- 1/2" #MS004A

**BLOW GUNS
(1/4" FEMALE INLETS)**



#200-RET



WITH RUBBER TIP #201-RET
REPLACEMENT TIP #202-D



#204-30A-RET*



WITH 3" EXTENSION
#204-303-D*



#208D*

* = SAFETY BYPASS TIPS

**RADIATOR FAUCET
(1/4" FEMALE INLET)**



#40-RD

**TIRE INFLATOR
WITH GAUGE & 12" HOSE**



#100D-RET



**BALL
FOOT
CHUCK**

1/4" FEMALE #104-D

HOSE CRIMPER



#855

COMES WITH 5 DIE BORE SIZES:
5/8", 37/64", 17/32", 31/64" & 11/16"



**BRASS
HOSE
FERRULE**

9 SIZES IN STOCK.
CALL WITH HOSE O.D.

3-IN-1 MANIFOLD

INLET:
1/4" NPT

OUTLETS:
1/4" NPT



#3404-RET

FILLER VALVE



1/8" MALE #AMF701
1/4" MALE #7012
VALVE CAP ONLY #943D

AIR PRESSURE GAUGE



20-120# #906-AD

THROTTLE VALVE

MALE x FEMALE



CONTROLS AIR FLOW FROM NEAR SHUT-OFF TO FULL FLOW.

1/4" #235-RET

**** WEBSITE ****

AMFLO



www.plews-edelmann.com

AIR QUICK DISCONNECT

INDUSTRIAL INTERCHANGE
(DOUBLE BAND ON COUPLER)
– STEEL –



COUPLER

PLUG

1/4" SERIES

	<u>COUPLER</u>	<u>PLUG</u>
1/4" MIP	C21	CP21
3/8" MIP	C21-03	CP21-03
1/4" FIP	C20	CP20
3/8" FIP	C20-23	CP20-23
1/4" BARB	C20-42	CP21-42
3/8" BARB	C20-44	CP21-44

3/8" SERIES

	<u>COUPLER</u>	<u>PLUG</u>
3/8" MIP	C25	CP25
3/8" FIP	C26	CP26
3/8" BARB	C26-44	CP25-44

1/2" SERIES

	<u>COUPLER</u>	<u>PLUG</u>
1/2" MIP	C9	CP17
1/2" FIP	C10	CP18
1/2" BARB	C10-45	CP17-45

GAS QUICK DISCONNECT
(FOR NATURAL GAS)



COUPLER

PLUG

<u>FEMALE</u>	<u>COUPLER</u>	<u>PLUG</u>
1/2"	HAN2	HAN1
3/4"	HAN6	HAN5
1"	HAN10	HAN9

AIR QUICK DISCONNECT

AUTOMOTIVE INTERCHANGE
(SINGLE BAND ON COUPLER)
– STEEL –



COUPLER

PLUG

1/4" SERIES

	<u>COUPLER</u>	<u>PLUG</u>
1/4" MIP	C1	CP1
3/8" MIP	C1-03	CP1-03
1/4" FIP	C2	CP2
3/8" FIP	C2-23	CP2-23
1/4" BARB	C2-42	CP1-42
3/8" BARB	C2-44	CP1-44

3/8" SERIES

	<u>COUPLER</u>	<u>PLUG</u>
3/8" MIP	C5	CP5
3/8" FIP	C6	CP6
3/8" BARB	C6-44	CP5-44

BRASS QUICK DISCONNECT
(FOR WATER APPLICATIONS)



COUPLER

PLUG

BRASS

	<u>COUPLER</u>	<u>PLUG</u>
<u>MALE:</u>		
1/4"	BRC3100	BRPB10
3/8"	BRC4300	BRPB42
1/2"	BRC5300	BRPB54
3/4"	BRC6500	BRPB66A

	<u>COUPLER</u>	<u>PLUG</u>
<u>FEMALE:</u>		
1/4"	BRC3000	BRPB11B
3/8"	BRC4200	BRPB43
1/2"	BRC5200	—
3/4"	BRC6400	—

COMBINATION AIR FILTER & REGULATOR

COMBINES THE FUNCTIONS OF A FILTER & PRESSURE REGULATOR INTO ONE COMPACT UNIT



0-160# GAUGE INCLUDED

1/4"	#FR2
3/8"	#FR3
1/2"	#FR5
3/4"	#FR7
1"	#FR10

REGULATOR WALL MOUNT BRACKET



FITS:

1/4" MINI	#18-025-003
1/4" & 3/8"	#4424-50
1/2" & 3/4"	#4324-50
1"	#5570-04

DRIP LEG DRAIN

FOR USE IN COMPRESSED AIR LINES TO AUTOMATICALLY EXPEL LIQUIDS FROM THE PIPING SYSTEM



1/2" FEMALE TOP INLET
#17-016-107

BRASS HEX NIPPLE



SEE PAGE 32

AIR PRESSURE REGULATOR



0-160# GAUGE INCLUDED

1/4"	#REG2
3/8"	#REG3
1/2"	#REG5
3/4"	#REG7
1"	#REG10

MAXIMUM INLET: 300#

OUTLET RANGES:

1/4" - 3/4"	5-150#
1"	5-125#

LARGER REGULATORS AVAILABLE

AIR FILTER / WATER SEPARATOR



REMOVES SOLID & LIQUID PARTICLES

MANUAL DRAIN

1/4"	#FIL2
3/8"	#FIL3
1/2"	#FIL5
3/4"	#FIL7
1"	#FIL10

AUTOMATIC DRAIN OPTION
IN STOCK

COALESCING (OIL REMOVAL):

3/8"	#FILC3
1/2"	#FILC5
3/4"	#FILC7

MINIATURE FILTER-REGULATOR-LUBRICATOR



MINI:

1/4" FILTER	#FIL2M
1/4" REGULATOR	#REG2M
1/4" LUBRICATOR	#LUB2M

1/4" COMBINATION
FILTER/REGULATOR #FR2M

AIR LUBRICATOR



LUBRICATES AIR TOOLS, CYLINDERS AND OTHER AIR-DRIVEN DEVICES

1/4"	#LUB2
3/8"	#LUB3
1/2"	#LUB5
3/4"	#LUB7
1"	#LUB10

AIR TOOL OIL



LIGHT PNEUMATIC TOOL OIL

PINT #1220-1

**** WEBSITE ****



NORGREN

www.usa.norgren.com

**PIPE INSULATION
(FIBERGLASS)**



FIBERGLASS
3' LENGTHS
1" WALL
TEMP RANGE: 0°F - 1000°F

<u>COPPER</u>	<u>STEEL, PLASTIC</u>	
1/2"	—	#FGI1
3/4"	1/2"	#FGI2
1"	3/4"	#FGI3
1-1/4"	1"	#FGI4
1-1/2"	1-1/4"	#FGI5
—	1-1/2"	#FGI6
—	2"	#FGI7
2"	—	#FGI8
2-1/2"	—	#FGI9C
—	2-1/2"	#FGI9
—	3"	#FGI10
3"	—	#FGI10C
—	4"	#FGI11
4"	—	#FGI11C
—	6"	#FGI12

**WHITE
PVC
TAPE**



2" x 100' #705610

**INSULATION
TAPE**



3" x 150' #705320

**INSULATION
FITTINGS**

TEE'S, 90'S &
45'S
IN STOCK



www.speedlinepvc.com

**PIPE INSULATION
(FOAM)**

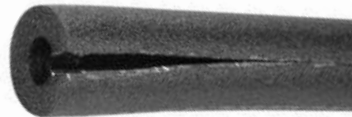

FOAM
6' LENGTHS
3/4" WALL
TEMP RANGE: 110°F - 210°F

<u>COPPER</u>	<u>STEEL, PLASTIC</u>	
1/2"	—	#58DT
3/4"	1/2"	#78DT
—	3/4"	#1DT
1"	—	#118DT
1-1/4"	1"	#138DT
1-1/2"	1-1/4"	#158DT
—	1-1/2"	#2DT
2"	—	#218DT
—	2"	#238DT
2-1/2"	—	#258DT
—	2-1/2"	#278DT
3"	—	#318DT
—	3"	#358DT
4"	—	#418DT
—	4"	#412DT

**CORK INSULATION
TAPE**



**SELF
ADHESIVE
ROLL**

STOPS SWEATING
AND CONDENSATION

1/8" x 2" x 30'

#4217-W3

WELL SEAL, ABS



<u>CASING I.D.</u>	<u>DROP PIPE</u>	
4" x	1"	#PJ4X1
4" x	1-1/4"	#PJ4X114
4" x	2"	#PJ4X2

OTHER SIZES AVAILABLE



**DOUBLE
TAPPED
BUSHING
BLACK**

(TANK BUSHING)

1" x	1/2" x	1/2"	#BBDT105
1-1/2" x	1" x	1"	#BBDT1510
2" x	3/4" x	3/4"	#BBDT207
2" x	1" x	1"	#BBDT2010
2" x	1-1/4" x	1-1/4"	#BBDT2012
2" x	1-1/2" x	1-1/2"	#BBDT2015
3" x	1" x	1"	#BBDT3010
4" x	1-1/2" x	1-1/2"	#BBDT4015
4" x	2" x	2"	#BBDT4020
4" x	2-1/2" x	2-1/2"	#BBDT4025
4" x	3" x	3"	#BBDT4030



NEED HELP?

**GIVE US
A CALL.**

(714) 241-7050

**FULL CIRCLE
REPAIR CLAMP**



PIPE SIZE	LENGTH	
1-1/2" x	6"	#FCC1560
2" x	6"	#FCC2060
2-1/2" x	6"	#FCC2560
3" x	7-1/2"	#FCC3075
4" x	7-1/2"	#FCC4075
6" x	12"	#FCC6012
8" x	12"	#FCC8012

BRASS PIPE SADDLE

FITS
IRON/
PLASTIC
PIPE
SIZE



PIPE SIZE	OUTLET	
3/4" x	1/2"	#451-403
1" x	3/4"	#451-504
1-1/4" x	1"	#451-605
1-1/2" x	1"	#451-705
2" x	1"	#451-805

**STEEL REPAIR
COUPLING**



PIPE SIZE	LENGTH	
1-1/2" x	5"	#SRC1550
2" x	5"	#SRC2050
2-1/2" x	5"	#SRC2550
3" x	5"	#SRC3050
4" x	5"	#SRC4050
6" x	5"	#SRC6050
8" x	5"	#SRC8050

IRON PIPE SADDLE



EPOXY
COATED

PIPE SIZE	OUTLET	
2" x	1"	#SAD2010
2-1/2" x	1"	#SAD2510
3" x	2"	#SAD3020
4" x	2-1/2"	#SAD4025
6" x	2-1/2"	#SAD6025
8" x	2-1/2"	#SAD8025

PIPE REPAIR CLAMP



IPS = IRON/PLASTIC PIPE SIZE
CTS = COPPER TUBE SIZE

3" LONG:

IPS	CTS	
3/8"	1/2"	#COL2
1/2"	3/4"	#COL3
3/4"	1"	#COL4
1"	1-1/4"	#COL5
1-1/4"	1-1/2"	#COL6
1-1/2"	—	#COL7
2"	—	#COL8
—	2"	#COL8C
2-1/2"	—	#COL9
—	2-1/2"	#COL9C
3"	—	#COL10
—	3"	#COL10C
4"	—	#COL12
—	4"	#COL12C
6"	6"	SEE BELOW
8"	—	SEE BELOW

6" LONG:

IPS	CTS	
3/8"	1/2"	#COL17
1/2"	3/4"	#COL18
3/4"	1"	#COL19
1"	1-1/4"	#COL20
1-1/4"	1-1/2"	#COL21
1-1/2"	—	#COL22
2"	—	#COL23
—	2"	#COL23C
2-1/2"	—	#COL24
—	2-1/2"	#COL24C
3"	—	#COL25
—	3"	#COL25C
4"	—	#COL27
—	4"	#COL27C
6"	—	#COL28
—	6"	#COL28C
8"	—	#COL29



**BRASS COMPRESSION
REPAIR COUPLING**

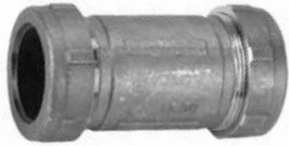

IPS = IRON/PLASTIC PIPE SIZE
CTS = COPPER TUBE SIZE

5" LONG:

IPS	CTS	
3/8"	1/2"	#BRCC53
1/2"	3/4"	#BRCC55
3/4"	1"	#BRCC57
1"	1-1/4"	#BRCC510
1-1/4"	1-1/2"	#BRCC512
1-1/2"	—	#BRCC515
2"	—	#BRCC520
—	2"	#BRCC520C

**GALVANIZED
COMPRESSION
REPAIR COUPLING**



PIPE SIZE	
1/2"	#GCC5
3/4"	#GCC7
1"	#GCC10
1-1/4"	#GCC12
1-1/2"	#GCC15
2"	#GCC20

We gladly accept...



**PVC COMPRESSION
REPAIR COUPLING**



PIPE SIZE	
1/2"	#S110-05
3/4"	#S110-07
1"	#S110-10
1-1/4"	#S110-12
1-1/2"	#S110-15
2"	#S110-20
2-1/2"	#S110-25
3"	#S110-30
4"	#S110-40
6"	#S110-60

**PVC SLIP-FIX
COUPLING**



TELESCOPING

PIPE SIZE	
1/2"	#S119-05
3/4"	#S119-07
1"	#S119-10
1-1/4"	#S119-12
1-1/2"	#S119-15
2"	#S119-20
2-1/2"	#S119-25
3"	#S119-30
4"	#S119-40
6"	#S119-60

PVC PIPE SADDLES



CLAMP-ON STYLE

PIPE SIZE	OUTLET (GLUED)	
2"	x 1-1/2"	#866-251
2-1/2"	x 1-1/2"	#866-291
3"	x 2"	#866-338
4"	x 2"	#866-420
4"	x 3"	#866-422
6"	x 2"	#866-528
6"	x 4"	#866-532
8"	x 2"	#866-578
8"	x 4"	#866-582



GLUE-ON STYLE

PIPE SIZE	OUTLET (GLUED)	
2-1/2"	x 3/4"	#463-288
3"	x 2"	#463-338
4"	x 2"	#463-420
6"	x 4"	#463-532
8"	x 4"	#463-582

**PVC COMPRESSION
x MALE ADAPTER**



1/2"	#S130-05
3/4"	#S130-07
1"	#S130-10
1-1/4"	#S130-12
1-1/2"	#S130-15
2"	#S130-20

**NATURAL GAS
FLEX CONNECTOR**



STAINLESS STEEL BRAID,
COMMERCIAL APPLICATIONS
18" LONG

1/2"	#VFCG518
3/4"	#VFCG718
1"	#VFCG1018
1-1/4"	#VFCG1218
1-1/2"	#VFCG1518
2"	#VFCG2018

LARGER SIZES AVAILABLE

**NATURAL GAS
FLEX CONNECTOR**



VINYL COVERED,
RESTAURANT APPLICATIONS

PIPE SIZE		LENGTH	
1/2"	x	24"	#HOM2
1/2"	x	36"	#HOM3
1/2"	x	48"	#HOM4
1/2"	x	60"	#HOM5
3/4"	x	24"	#HOM7
3/4"	x	36"	#HOM8
3/4"	x	48"	#HOM9
3/4"	x	60"	#HOM10
1"	x	24"	#HOM12
1"	x	36"	#HOM13
1"	x	48"	#HOM14
1	x	60"	#HOM15

**APPLIANCE
RESTRAINING
DEVICE**



3' - 5' #HOM22

**VIBRATION FLEX
CONNECTOR**



STAINLESS STEEL BRAID WITH
CARBON STEEL MALE ENDS.

ABSORBS PUMP VIBRATION,
NOISE AND REDUCES PIPING
STRESS DUE TO MINOR
MISALIGNMENT

PIPE SIZE		LENGTH	
1/2"	x	10"	#VFC5
3/4"	x	11"	#VFC7
1"	x	12"	#VFC10
1-1/4"	x	13"	#VFC12
1-1/2"	x	14"	#VFC15
2"	x	15"	#VFC20
2-1/2"	x	15"	#VFC25
3"	x	16"	#VFC30



**FLANGED
ENDS**

PIPE SIZE		LENGTH	
2-1/2"	x	9"	#VFCF25
3"	x	9"	#VFCF30
4"	x	9"	#VFCF40

OTHER SIZES, MATERIALS AND
LENGTHS AVAILABLE

**OTHER
FLEX CONNECTORS**



SEE PAGE 185

**BRONZE
VIBRATION CONNECTOR**



BRONZE HOSE AND BRAID WITH
BRASS MALE ENDS

PIPE SIZE		LENGTH	
1/2"	x	10"	#VFCB5
3/4"	x	11"	#VFCB7
1"	x	12"	#VFCB10
1-1/4"	x	13"	#VFCB12
1-1/2"	x	14"	#VFCB15
2"	x	15"	#VFCB20

OTHER SIZES AND LENGTHS
AVAILABLE

EXPANSION JOINT



NEOPRENE/RUBBER
SINGLE SPHERE
GOOD TO 180°F
6" LONG

PIPE SIZE		
2"		#EXJ20
2-1/2"		#EXJ25
3"		#EXJ30
4"		#EXJ40
6"		#EXJ60
8"		#EXJ80

DOUBLE SPHERE AVAILABLE

DIELECTRIC UNION

**FOR
NATURAL
GAS**

(BLACK)



FEMALE THREADED

1/2"	#DUNG5
3/4"	#DUNG7
1"	#DUNG10
1-1/4"	#DUNG12
1-1/2"	#DUNG15
2"	#DUNG20

**FLANGE INSULATION
KIT - DIELECTRIC**



KIT INCLUDES:

- 1/8" FULL FACE GASKET
- POLY SLEEVES
- PHENOLIC WASHERS
- STEEL WASHERS

2"	#DFK20
2-1/2"	#DFK25
3"	#DFK30
4"	#DFK40
6"	#DFK60
8"	#DFK80

DIELECTRIC UNIONS



F.I.P. x SOLDER

FOR USE WHEREVER DISSIMILAR METALS OCCUR IN PIPING AND PLUMBING SYSTEMS.

1/2"	#DUFS5
3/4"	#DUFS7
1"	#DUFS10
1-1/4"	#DUFS12
1-1/2"	#DUFS15
2"	#DUFS20

LARGER SIZES, SEE BELOW



FLANGED

**F.I.P. x
SOLDER**

2-1/2"	#DUFS25
3"	#DUFS30
4"	#DUFS40



F.I.P. x F.B.P.

IRON PIPE THREAD x BRONZE PIPE THREAD

1/2"	#DUFF5
3/4"	#DUFF7
1"	#DUFF10
1-1/4"	#DUFF12
1-1/2"	#DUFF15
2"	#DUFF20

**DIELECTRIC ADAPTER,
FLANGED**



COPPER FLANGE ADAPTER

FOR USE WHEN GOING FROM AN IRON FLANGE TO COPPER TUBING

LOOSE RING STEEL FLANGE

2"	#CFA20
2-1/2"	#CFA25
3"	#CFA30
4"	#CFA40

LARGER SIZES AVAILABLE

GASKET & HARDWARE SOLD SEPARATELY

INSULATED COUPLING



**FEMALE x
FEMALE**

1/2"	#INC5
3/4"	#INC7
1"	#INC10
1-1/4"	#INC12
1-1/2"	#INC15
2"	#INC20

FLEXIBLE COUPLING

**RUBBER WITH
STAINLESS STEEL
CLAMPS**



CI = CAST IRON
PL = ABS OR PVC

CI/PL x CI/PL	
1-1/2"	#MR56-15
2"	#MR56-22
3"	#MR56-33
4"	#MR56-44
5"	#MR56-55
6"	#MR56-66
8"	#MR56-88
10"	#MR56-1010
12"	#MR56-1212
2" x 1-1/2"	#MR56-215
3" x 2"	#MR56-32
4" x 1-1/2"	#MR56-415
4" x 2"	#MR56-42
4" x 3"	#MR56-43
5" x 4"	#MR56-54
6" x 4"	#MR56-64
6" x 5"	#MR56-65
CLAY x CI/PL	
4"	#MR02-44
6"	#MR02-66
8"	#MR02-88
4" x 3"	#MR02-43
6" x 4"	#MR02-64
8" x 6"	#MR02-86
CLAY x CLAY	
4"	#MR01-44
6"	#MR01-66
8"	#MR01-88
6" x 4"	#MR01-64
8" x 6"	#MR01-86
CLAY x PL (DONUT ONLY)	
4"	#0504423
6"	#0506428
4" x 3"	#0503425

TRANSITION COUPLING



FOR CONNECTING DIFFERENT
MATERIALS AND SIZES

CI = CAST IRON
PL = ABS OR PVC
ST = STEEL
COP = COPPER

1-1/2"	CI,PL,ST	x 1-1/2"	PL,ST	#CP150
2"	CI,PL,ST	x 1-1/2"	PL,ST	#CP215
2"	CI,PL,ST	x 2"	PL,ST	#CP200
3"	CI	x 3"	PL,ST	#CP33
4"	CI	x 3"	PL,ST	#CP43
4"	CI	x 4"	PL,ST	#CP44
6"	CI	x 6"	PL,ST	#CP66
3"	CI	x 2"	CI,PL,ST	#C320
4"	CI	x 2"	CI,PL,ST	#MC420
4"	CI	x 3"	CI	#MC430
1-1/2"	CI,PL,ST	x 1-1/2"	COP	#CK115
2"	CI,PL,ST	x 1-1/2"	COP	#CK215
2"	CI,PL,ST	x 2"	COP	#CK22
3"	CI	x 2"	COP	#CK32
3"	CI	x 3"	COP	#CK33
4"	CI	x 3"	COP	#CK43
4"	CI	x 4"	COP	#CK44
1-1/2"	COP	x 1-1/2"	COP	#K150
2"	COP	x 2"	COP	#K200
2"	COP	x 1-1/2"	CI,PL,ST	#KC215
3"	COP	x 2"	CI,PL,ST	#KC32
3"	PL,ST	x 3"	PL,ST	#P300
4"	PL,ST	x 3"	PL,ST	#P430
4"	PL,ST	x 4"	PL,ST	#P400
3"	PL,ST	x 2"	CI,PL,ST	#PC32
4"	PL,ST	x 3"	CI	#PC43
1-1/2"	TUBE O.D.	x 1-1/2"	CI,PL,ST	#T150
1-1/2"	TUBE O.D.	x 2"	CI,PL,ST	#T215
THINWALL				
3"	PLASTIC	x 3"	PVC S/40	#TWP33
4"	PLASTIC	x 3"	PVC S/40	#TWP43
4"	PLASTIC	x 4"	PVC S/40	#TWP44

PIPE LABELS



4 LABELS PER CARD
LABEL SIZES: 1-1/8" x 7"

ARROW (6 PER CARD)	#93242
ACID	#92001
AIR	#77267
AIR COND. WATER	#36275
BOILER FEED	#92015
CAUSTIC	#79216
CHEMICAL	#79937
CHILLED WATER	#76998
CITY WATER	#92067
COLD WATER	#92068
COMPRESSED AIR	#79316
CONDENSATE	#79294
COOLING WATER	#79348
DEIONIZED WATER	#92071
DOMESTIC	#92023
DRAIN	#93101
DRINKING WATER	#92074
FIRE AUTO SPRINKLERS	#79206
HEATING	#93122
HIGH PRESSURE	#79766
HIGH PRESSURE AIR	#79317
HOT WATER	#92078
INDUSTRIAL WATER	#79349
LOW PRESSURE	#79765
LOW PRESSURE AIR	#79314
MAKE-UP WATER	#79338
NATURAL GAS	#79236
NITROGEN	#79315
NON-POTABLE WATER	#79228
OXYGEN	#93154
PLANT AIR	#93301
PLANT WATER	#79847
POTABLE WATER	#79226
PROCESSED WATER	#79749
RECLAIMED WATER	#04222A
RETURN	#93161
SEWER	#79281
STEAM	#92051
SUPPLY	#93177
TREATED WATER	#79345
VACUUM	#92060
WASTE WATER	#79346
WATER	#93205

**CUSTOM LABELS AVAILABLE,
1-2 DAY DELIVERY**



**ARROW
TAPE,
ROLL**

1" x 36 YARD #91424
2" x 36 YARD #91420



**OTHER
TAPES**

SEE
PAGES
218-219

BRASS TAGS



**1-1/2"
ROUND,
BRASS**

OTHER SIZES & SHAPES AVAILABLE.
CALL WITH YOUR REQUIREMENTS.

MARKING TAG



PURPLE

#ID-MAX-P2-RC006

"WARNING RECYCLED/RECLAIMED WATER
DO NOT DRINK"

ENGLISH & SPANISH

(YELLOW BLANK TAG: #ID-STD-YB)

SPEED-RAIL FITTINGS

**SIDE
OUTLET
90°**



1" #SRSO910
1-1/4" #SRSO912
1-1/2" #SRSO915

**SIDE
OUTLET
TEE**



1" #SRSOT10
1-1/4" #SRSOT12
1-1/2" #SRSOT15

**SIDE
OUTLET
CROSS**



1" #SRSOCR10
1-1/4" #SRSOCR12
1-1/2" #SRSOCR15

**ADJUSTABLE
90° OR TEE**



1" #SRA9T10
1-1/4" #SRA9T12
1-1/2" #SRA9T15

**ADJUSTABLE
CROSS**



1" #SRACR10
1-1/4" #SRACR12
1-1/2" #SRACR15

SPEED-DIAL FITTINGS

ALLEN SCREW CONNECTION.
USE WITH SCH. 40 PIPE.
AVAILABLE SIZES: 1/2" - 2"



90°

1" #SR910
1-1/4" #SR912
1-1/2" #SR915



TEE

1" #SRT10
1-1/4" #SRT12
1-1/2" #SRT15



CROSS

1" #SRCR10
1-1/4" #SRCR12
1-1/2" #SRCR15



COUPLING

1" #SRCO10
1-1/4" #SRCO12
1-1/2" #SRCO15

SPEED-RAIL FITTINGS



**SQUARE
FLOOR
FLANGE**

1" #SRSFF10
1-1/4" #SRSFF12
1-1/2" #SRSFF15



**RECTANGULAR
FLOOR
FLANGE**

1" #SRRFF10
1-1/4" #SRRFF12
1-1/2" #SRRFF15

OTHER FLANGES AVAILABLE



**ADJUSTABLE
WALL
BRACKET**

1" #SRAWB10
1-1/4" #SRAWB12
1-1/2" #SRAWB15



**PIPE
PLUG**

1" #SRP10
1-1/4" #SRP12
1-1/2" #SRP15

FLANGE GASKETS

NON-ASBESTOS

**FULL FACE
150# & 300#
1/16" THICK**



GOOD TO 400°F

150#

- 1/2" #NAFG5
- 3/4" #NAFG7
- 1" #NAFG10
- 1-1/4" #NAFG12
- 1-1/2" #NAFG15
- 2" #NAFG20
- 2-1/2" #NAFG25
- 3" #NAFG30
- 4" #NAFG40
- 5" #NAFG50
- 6" #NAFG60
- 8" #NAFG80
- 10" #NAFG100
- 12" #NAFG120

300#

- 1/2" #NAFG35
- 3/4" #NAFG37
- 1" #NAFG310
- 1-1/4" #NAFG312
- 1-1/2" #NAFG315
- 2" #NAFG320
- 2-1/2" #NAFG325
- 3" #NAFG330
- 4" #NAFG340
- 6" #NAFG360
- 8" #NAFG380

LARGER SIZES AVAILABLE

FLANGE GASKETS

NEOPRENE (RUBBER)

**FULL FACE
150#
1/8" THICK**



GOOD TO 180°F

- 1/2" #NFG5
- 3/4" #NFG7
- 1" #NFG10
- 1-1/4" #NFG12
- 1-1/2" #NFG15
- 2" #NFG20
- 2-1/2" #NFG25
- 3" #NFG30
- 4" #NFG40
- 5" #NFG50
- 6" #NFG60
- 8" #NFG80
- 10" #NFG100
- 12" #NFG120

LARGER SIZES AVAILABLE

NON-ASBESTOS

**RING
150#
1/16" THICK**



GOOD TO 400°F

- 1/2" #NARG5
- 3/4" #NARG7
- 1" #NARG10
- 1-1/4" #NARG12
- 1-1/2" #NARG15
- 2" #NARG20
- 2-1/2" #NARG25
- 3" #NARG30
- 4" #NARG40
- 5" #NARG50
- 6" #NARG60
- 8" #NARG80
- 10" #NARG100
- 12" #NARG120

FLANGE GASKETS

TEFLON

**FULL FACE
150#
1/8" THICK**



GOOD TO 400°F

- 1/2" #TFG5
- 3/4" #TFG7
- 1" #TFG10
- 1-1/4" #TFG12
- 1-1/2" #TFG15
- 2" #TFG20
- 2-1/2" #TFG25
- 3" #TFG30
- 4" #TFG40
- 6" #TFG60
- 8" #TFG80

SPIRAL WOUND (METAL)

**RING
150#**



GOOD TO 450°F

- 1/2" #SWG5
- 3/4" #SWG7
- 1" #SWG10
- 1-1/4" #SWG12
- 1-1/2" #SWG15
- 2" #SWG20
- 2-1/2" #SWG25
- 3" #SWG30
- 4" #SWG40
- 6" #SWG60
- 8" #SWG80

TEFLON CORD PACKING



SEE PAGE 218

We gladly accept...



150# FLANGE DIMENSIONS

PIPE SIZE	OUTSIDE		
	DIA. OF FLANGE	BOLT CIRCLE	BOLT HOLES
1/2"	3-1/2"	2-3/8"	4
3/4"	3-7/8"	2-3/4"	4
1"	4-1/4"	3-1/8"	4
1-1/4"	4-5/8"	3-1/2"	4
1-1/2"	5"	3-7/8"	4
2"	6"	4-3/4"	4
2-1/2"	7"	5-1/2"	4
3"	7-1/2"	6"	4
3-1/2"	8-1/2"	7"	8
4"	9"	7-1/2"	8
5"	10"	8-1/2"	8
6"	11"	9-1/2"	8
8"	13-1/2"	11-3/4"	8
10"	16"	14-1/4"	12
12"	19"	17"	12
14"	21"	18-3/4"	12
16"	23-1/2"	21-1/4"	16

300# FLANGE DIMENSIONS

PIPE SIZE	OUTSIDE		
	DIA. OF FLANGE	BOLT CIRCLE	BOLT HOLES
1/2"	3-3/4"	2-5/8"	4
3/4"	4-5/8"	3-1/4"	4
1"	4-7/8"	3-1/2"	4
1-1/4"	5-1/4"	3-7/8"	4
1-1/2"	6-1/8"	4-1/2"	4
2"	6-1/2"	5"	8
2-1/2"	7-1/2"	5-7/8"	8
3"	8-1/4"	6-5/8"	8
4"	10"	7-7/8"	8
5"	11"	9-1/4"	8
6"	12-1/2"	10-5/8"	12
8"	15"	13"	12
10"	17-1/2"	15-1/4"	16
12"	20-1/2"	17-3/4"	16

SHEET GASKET MATERIAL



NEOPRENE (RUBBER)
150#
1/8" THICK

36" x 36" #SGMN36

GASKET SQUARES



12" x 12"

1/8" NEOPRENE #GSN2
1/16" NON-ASBESTOS #GSNA1

FORM-A-GASKET PERMATEX®



SEE PAGE 226

FLANGE NUT & BOLT KIT, STEEL



FITS
FLANGE SIZE

- 1/2", 3/4" & 1" #NBK10
- 1-1/4" & 1-1/2" #NBK15
- 2" #NBK20
- 2-1/2" & 3" #NBK30
- 4" #NBK40
- 5" & 6" #NBK60
- 8" #NBK80
- 10" & 12" #NBK120

STAINLESS STEEL NUT & BOLT KITS IN STOCK.
SEE PAGE 70

FLANGE INSULATION KIT – DIELECTRIC



KIT INCLUDES:

- 1/8" FULL FACE GASKET
- POLY SLEEVES
- PHENOLIC WASHERS
- STEEL WASHERS

- 2" #DFK20
- 2-1/2" #DFK25
- 3" #DFK30
- 4" #DFK40
- 6" #DFK60
- 8" #DFK80

HEX NUT

PLATED STEEL



- 1/4" #HN2
- 3/8" #HN3
- 1/2" #HN5
- 5/8" #HN58
- 3/4" #HN7

STAINLESS STEEL NUTS
SEE PAGE 70

FLAT WASHERS

PLATED STEEL



STANDARD USS:

- 1/4" #FW2
- 3/8" #FW3
- 1/2" #FW5
- 5/8" #FW58
- 3/4" #FW7

FENDER:

- 1/4" x 1" #FWF2
- 3/8" x 1-1/2" #FWF3
- 1/2" x 2" #FWF5

STAINLESS STEEL WASHERS
SEE PAGE 70

SPLIT LOCK WASHER

PLATED STEEL



- 1/4" #LW2
- 3/8" #LW3
- 1/2" #LW5
- 5/8" #LW58
- 3/4" #LW7

STAINLESS STEEL SPLIT
LOCK WASHERS, PAGE 70

HEX HEAD BOLT



PLATED STEEL

- 1/4" x 1" #HB210
- 1/4" x 1-1/2" #HB215
- 1/4" x 2" #HB220
- 1/4" x 2-1/2" #HB225
- 1/4" x 3" #HB230
- 5/16" x 1" #HB51610
- 3/8" x 1" #HB310
- 3/8" x 1-1/2" #HB315
- 3/8" x 2" #HB320
- 3/8" x 2-1/2" #HB325
- 3/8" x 3" #HB330
- 1/2" x 1" #HB510
- 1/2" x 1-1/2" #HB515
- 1/2" x 2" #HB520
- 1/2" x 2-1/2" #HB525
- 1/2" x 3" #HB530
- 1/2" x 3-1/2" #HB535
- 1/2" x 4" #HB540
- 5/8" x 1-1/4" #HB5812
- 5/8" x 1-3/4" #HB58134
- 5/8" x 2" #HB5820
- 5/8" x 2-1/4" #HB58214
- 5/8" x 2-1/2" #HB5825
- 5/8" x 3" #HB5830
- 5/8" x 3-1/2" #HB5835
- 5/8" x 4" #HB5840
- 5/8" x 4-1/2" #HB5845
- 5/8" x 5" #HB5850
- 5/8" x 5-1/2" #HB5855
- 5/8" x 6" #HB5860
- 3/4" x 1-3/4" #HB7134
- 3/4" x 2" #HB720
- 3/4" x 2-1/4" #HB7214
- 3/4" x 2-1/2" #HB725
- 3/4" x 3" #HB730
- 3/4" x 3-1/2" #HB735
- 3/4" x 4" #HB740
- 3/4" x 4-1/2" #HB745
- 3/4" x 5" #HB750
- 3/4" x 5-1/2" #HB755
- 3/4" x 6" #HB760
- 3/4" x 6-1/2" #HB765
- 3/4" x 7" #HB770

FOR STAINLESS STEEL
HARDWARE, SEE PAGE 70

SCREW KITS



**WOOD SCREW
ASSORTMENT
KIT
1" - 2-1/4" LONG**



335 PIECES #WR-6



**SHEET METAL
SCREW,
PAN HEAD**

**ASSORTMENT
KIT
1/2" - 2" LONG**



#8 300 PIECES #8PS
#10 210 PIECES #10PS

**RATCHET & SOCKET
TOOL**



SEE PAGE 254



**THREAD
LOCKER**

SEE PAGE 231

ANCHORS

WEDGE ANCHOR



STEEL:

- 1/4" x 2-1/4" #W14-214
- 1/4" x 3-1/4" #W14-314
- 3/8" x 3" #W38-300
- 3/8" x 3-3/4" #W38-334
- 1/2" x 4-1/4" #W12-400

STAINLESS STEEL:

- 1/4" x 2-1/4" #WS14-214
- 3/8" x 3" #WS38-300
- 1/2" x 4" #WS12-400

DROP-IN ANCHOR



- 1/4" #DA-25
- 3/8" #DA-38
- 1/2" #DA-50
- 5/8" #DA-58
- 3/4" #DA-75

DROP-IN ANCHOR TOOL



- 1/4" #AT-25
- 3/8" #AT-38
- 1/2" #AT-50
- 5/8" #AT-58

ZAMAC ANCHOR



- 1/4" x 1" #ZA-100
- 1/4" x 1-1/4" #ZA-125
- 1/4" x 1-1/2" #ZA-150

ANCHOR KITS



SHEET METAL SCREW, PAN HEAD

100 PIECES



- #6 x 1" #1-AK
- #10 x 1" #2-AK
- #12 x 1-1/2" #3-AK*

INCLUDES MASONRY BIT. *50 PIECES.



SHEET METAL SCREW, HEX HEAD

100 PIECES



- #10 x 1" #2-AKHX

INCLUDES MASONRY BIT

TOGGLE BOLT



4" LONG

- 3/16" #TBC-364
- 1/4" #TBC-44
- 3/8" #TB-384

ANCHOR KITS



WALL DRILLER KIT

50 PIECES



- #8 x 1-1/4" #WDK-8



WALL DRILLER TOGGLE KIT

25 PIECES



- 3/16" x 3" #WDT-363



MASONRY SCREW, HEX HEAD

100 PIECES



- #8 x 1-1/4" #HX-DOG
- INCLUDES MASONRY BIT & MAGNETIC HEX TOOL.

SCREWS



DRYWALL SCREW

- #6 x 1" #DWSBX61
- #6 x 1-1/4" #DWSBX6114
- #6 x 1-5/8" #DWSBX6158
- #6 x 2" #DWSBX62

(100 PER BOX)



**WOOD SCREW
FLATHEAD – PHILLIPS**

- #8 x 1" #PHFW81
- #8 x 1-1/2" #PHFW8112
- #8 x 2" #PHFW82
- #10 x 1" #PHFW101
- #10 x 1-1/2" #PHFW10112
- #10 x 2" #PHFW102
- #12 x 1" #PHFW121
- #12 x 1-1/2" #PHFW12112
- #12 x 2" #PHFW122

(100 PER BOX)



**SHEET METAL SCREW
PAN HEAD – PHILLIPS**

- #10 x 3/4" #2WS1034
- #10 x 1" #2WS101
- #10 x 1-1/2" #2WS10112
- #10 x 2" #2WS102

(100 PER BOX)

SCREWS



**TEK SCREW
SHEET METAL SCREW
HEX HEAD**

- #8 x 1/2" #TEKHW812
- #8 x 3/4" #TEKHW834
- #8 x 1" #TEKHW81
- #10 x 1/2" #TEKHW1012
- #10 x 3/4" #TEKHW1034
- #10 x 1" #TEKHW101

(100 PER BOX)

**FLAT WASHER FOR TEK SCREWS
#FW10**



**SHARPEEZ
SHEET METAL SCREW
HEX HEAD, SLOTTED**

- #8 x 1/2" #SP812
- #8 x 3/4" #SP834

(100 PER BOX)



**SHEET METAL SCREW
HEX WASHER HEAD
SLOTTED**

- #10 x 3/4" #HWSMS1034
- #10 x 1" #HWSMS101
- #10 x 1-1/2" #HWSMS10112
- #10 x 2" #HWSMS102

(100 PER BOX)

BITS & TOOLS



**MAGNETIC HEX TOOL
(FOR HEX HEAD SCREWS)**

SCREW SIZE		
1/4"	#8	#MT8
5/16"	#10	#MT10



POWER BIT – PHILLIPS

#IB2PL



**INSERT BIT HOLDER
MAGNETIC**

#MBH

DRIVE SCREW



#16 x 2" #DS162

LAG SCREW



1/4"	x	1-1/2"	#LB215
1/4"	x	2"	#LB220
3/8"	x	2"	#LB320
3/8"	x	3"	#LB330



SUBMERSIBLE PUMPS

AUTOMATIC PUMP

PLASTIC HOUSING



#55-ASP

1-1/4" DISCHARGE
WITH 3/4" GARDEN HOSE
ADAPTER
1/4 H.P.
1800 GPH @ 10' HEAD
25' MAX HEAD
PASSES 3/8" SOLIDS
10' POWER CORD

MANUAL PUMP



#14EH - CIM

2" DISCHARGE
1/2 H.P.
3600 GPH @ 20' HEAD
50' MAX HEAD
PASSES 3/4" SOLIDS
20' POWER CORD - 82#

FOR AUTOMATIC OPERATION:
- FLOAT SWITCH #RFSN-16

FOUNTAIN PUMP

1/4" OUTLET

#P-AAA



120 GPH @ 1' HEAD
5' MAX HEAD

SUBMERSIBLE PUMPS

LittleGIANT



MANUAL PUMP

#5-MSP

1" DISCHARGE
WITH 3/4" GARDEN HOSE
ADAPTER
1/6 H.P.
1100 GPH @ 5' HEAD
26' MAX HEAD
10' POWER CORD

FOR AUTOMATIC OPERATION:
- PRESSURE SWITCH #RS5
- FLOAT SWITCH #RFSN-9

www.littlegiant.com



AUTOMATIC PUMP

#6-CIA

1-1/2" DISCHARGE
1/3 H.P.
1740 GPH @ 10' HEAD
18' MAX HEAD
8' POWER CORD



AUTOMATIC PUMP

#6E-CIA-SFS

1-1/2" DISCHARGE
1/3 H.P.
2500 GPH @ 10' HEAD
20' MAX HEAD
PASSES 1/2" SOLIDS
10' POWER CORD

SEWAGE PUMP SUBMERSIBLE



AUTOMATIC SEWAGE PUMP

#10S-CIA-SFS

2" DISCHARGE
1/2 H.P.
5100 GPH @ 10' HEAD
20' MAX HEAD
PASSES 2" SOLIDS
10' POWER CORD - 46#

WATER REMOVAL PUMP SYSTEM



REMOVES WATER FROM LAUNDRY TRAYS, SINKS, ETC. WHERE GRAVITY DRAINAGE IS IMPRACTICAL.

POLYPROPYLENE TANK SIZE:
3-1/2" GALLON #WRSC-6
5" GALLON #WRS-6

INCLUDES #6-CIA PUMP
1/3 H.P.
1740 GPH @ 10' HEAD
18' MAX HEAD
8' POWER CORD
1-1/2" SIDE INLET
1-1/2" TOP DISCHARGE
2" TOP VENT PORT

HAND PUMPS



SEE PAGE 250

SUBMERSIBLE PUMPS



**ZOELLER
AUTOMATIC
PUMP**



9' POWER CORD #M53
25' POWER CORD #M53-25

1-1/2" DISCHARGE
1/3 H.P.
PASSES 1/2" SOLIDS

www.zoeller.com

**ZOELLER
AUTOMATIC
PUMP**



10' POWER CORD #M267

2" DISCHARGE
1/2 H.P.
PASSES 2" SOLIDS

**PUMP WELL
STRAINER**

**FEMALE
INLET**



1-1/2" #RHS-20
2" #RHS-25
2-1/2" #RHS-30
3" #RHS-35
4" #RHS-40

AVAILABLE UP TO 12"

**BACKWATER VALVES
FOR SUBMERSIBLE PUMPS**



**PLASTIC
(ABS)**

1-1/2" #300181
2" #300021



**CAST
IRON**

2" #300151

FOOT CHECK VALVE



**IRON
BODY**

FEMALE
1-1/2" #DFVS-20
2" #DFVS-25
2-1/2" #DFVS-30
3" #DFVS-35
4" #DFVS-40

AVAILABLE UP TO 12"

FOOT CHECK VALVE



**BRASS
BODY**
**STAINLESS
SCREEN**

1-1/2" FEMALE #527T07
2" FEMALE #527T08

CONDENSATE PUMP



**AUTOMATIC
PUMP**

CONDENSATE REMOVAL PUMP
#VCMX-20ULS

3/8" OUTLET
(INCLUDES BARB ADAPTER)
80 GPH @ 5' HEAD
20' MAX HEAD
1/2 GALLON TANK
6' POWER CORD

UTILITY PUMP



#PP1

GARDEN HOSE ENDS, QUICKLY
DRAINS WATER HEATERS OR
GOOD FOR MANY OTHER USES.

**AQUARIUM PUMP
MAGNETIC DRIVE**



**SALT OR
FRESH
WATER**

#2-MDQ-SC

1/2" CONNECTION
1/30 H.P.
465 GPH @ 3' HEAD
6' POWER CORD

PUMP FLANGE SET

FOR
BELL &
GOSSETT
PUMPS



2 FLANGES PER SET

3/4"	#101011
1"	#101012
1-1/4"	#101013
1-1/2"	#101014

PUMP COUPLER

FOR
BELL &
GOSSETT
PUMPS



- #118705
- #189110
- #118473

BEARING ASSEMBLY

FOR
BELL &
GOSSETT
PUMPS



#189034

MANY OTHERS AVAILABLE



OTHER PARTS IN STOCK

CIRCULATING PUMPS



BELL &
GOSSETT



#100-BNFI

1/12 H.P.
OIL LUBRICATED.
FLANGES SOLD SEPARATELY



#NBF-22

FLANGES SOLD SEPARATELY



#NBF-12F

FLANGES SOLD SEPARATELY



#NBF-9U

UNION CONNECTION

3/4"	SWEAT	#UC34S
3/4"	THREADED	#UC34NPT

CENTRIFUGAL PUMPS



BELL & GOSSETT

SERIES 80
IN-LINE MOUNTED
CENTRIFUGAL PUMP

CALL WITH YOUR
REQUIREMENTS



BELL & GOSSETT

SERIES 1510
END SUCTION
CENTRIFUGAL PUMP

CALL WITH YOUR
REQUIREMENTS

HEAT EXCHANGER



CALL WITH YOUR
REQUIREMENTS

**** WEBSITE ****



BELL &
GOSSETT

www.bellgossett.com

CIRCULATING PUMPS
GRUNDFOS

FLANGED ENDS

VARIABLE SPEED



#UPS15-35SFC

FLANGED ENDS

VARIABLE SPEED



#UPS15-55SFC

FLANGED ENDS
HIGH HEAD PUMP

1/12 H.P. #UP26-96BF
FOR USE WITH TANKLESS WATER HEATERS



FLANGED ENDS

1/6 H.P. #UP43-75BF



CIRCULATING PUMPS
GRUNDFOS



#UP15-29SU

UNION ENDS



#UP15-29SF

FLANGED ENDS



#UP15-10B5

1/2" SWEAT ENDS

**** WEBSITE ****



GRUNDFOS

www.grundfos.com
(USA)

PUMP FLANGE SETS



FOR GRUNDFOS PUMPS

2 FLANGES PER SET

3/4" #519651
1" #519652
1-1/2" #539615



FOR GRUNDFOS PUMPS

WITH SHUT-OFF
3/4" FLANGED
#519755



FOR GRUNDFOS PUMPS

WITH SHUT-OFF
3/4" COMPRESSION
#519851

(FOR UNION END PUMPS)



GRUNDFOS ACCESSORIES

24 HOUR PUMP TIMERS &
THERMOSTATIC CONTROLS
IN STOCK

SHOWER DRAINS

**ALL
CAST
IRON**



2" OUTLET

COMPRESSION INSTA-SET
#ABA564

NO-HUB CONNECTION
#ABA562

FEMALE THREAD
#ABA5065



**ALL
PLASTIC
ABS**



2" GLUE-ON #ABA5000



**CAST IRON
TOP**



**ABS PLASTIC
BOTTOM**

2" GLUE-ON #ABA5040
2" SURE-FIT #ABA5050



**FOR
FIBERGLASS
SHOWER
STALLS**



2" SURE-FIT CONNECTION

PLASTIC #ABA3200
BRASS #ABA6508

FLOOR DRAIN

**- AB & A -
NICKEL BRONZE TOP**



**5"
ADJUSTABLE
STRAINER
TOP**

**NO-HUB
OUTLET**

2" #ABA502
3" #ABA503
4" #ABA504

LESS FLASHING RING:
2" #ABA512
(4" TOP)



FLOOR CLEANOUTS



**COVER
ONLY**

(NO CLEANOUT PLUG)

FITS OVER
2" & 3" PIPE #ABA553
4" PIPE #ABA554



**COMPLETE
ASSEMBLY**

(WITH CLEANOUT PLUG)

**NO-HUB
OUTLET**
3" #ABA546
4" #ABA547

FLOOR DRAIN

**- J.R. SMITH -
NICKEL BRONZE TOP**



**CAST IRON BODY
NO-HUB OUTLET**

5" ROUND TOP:
2" #2005YA20
3" #2005YA30
4" #2005YA40

5" SQUARE TOP:
2" #2005YB20
3" #2005YB30
4" #2005YB40

GRID STRAINERS ONLY



(FOR J.R. SMITH DRAINS)

4-3/4" ROUND #A5NBG
5-5/8" ROUND #A6NBG
4-1/2" SQUARE #B5NBG
5-1/2" SQUARE #B6NBG

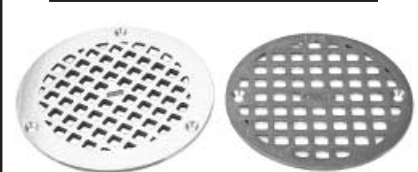

(FOR ZURN DRAINS)

5" ROUND #PN4005B
4-1/2" SQUARE #PN4005S

(FOR FPM DRAINS)

3-1/2" ROUND #4375R
4-5/8" ROUND #5375R

**FLOOR DRAINS,
LARGE**

**CAST
IRON
BODY
& TOP**



**MEDIUM DUTY
4" NO-HUB OUTLET**

COMPLETE DRAIN:

8" TOP #2110Y40
11-1/2" TOP #2131Y40

GRATE ONLY:

8" DIA. #2110G
11-1/2" DIA. #2130G

www.jrsmith.com

**CAST
IRON
BODY
& TOP**



**HEAVY DUTY
4" NO-HUB OUTLET**

COMPLETE DRAIN:

11-1/2" TOP #2141Y40

GRATE ONLY:

11-1/2" DIA. #2140G
(1-3/8" DEEP)

**FLOOR DRAIN
WITH STRAINER**

**CAST
IRON
WITH
SEDIMENT
BASKET**



**MEDIUM DUTY
4" NO-HUB OUTLET**

COMPLETE DRAIN:

8" TOP #2210Y40

ROOF DRAINS



**CAST IRON
BODY &
STRAINER**

**9" SQUARE BASE
NO-HUB OUTLET**

2" #ABA572
3" #ABA573
4" #ABA574



**CAST IRON
BODY &
STRAINER**

**15-1/2" ROUND BASE
NO-HUB OUTLET**

3" #1010Y30
4" #1010Y40
6" #1010Y60



**ROOF
DRAIN**

**STRAINER
ONLY**

11-1/4" DIAMETER – 5" TALL

PLASTIC #1010DP
CAST IRON #1010CID



**CAST IRON
BODY &
STRAINER**

**WITH OVERFLOW DRAIN
NO-HUB OUTLET**

3" #ABA603
4" #ABA604

ROOF DRAIN



**PLASTIC
BODY &
STRAINER**

**CONNECTS TO DRAIN
WITH RUBBER FLEX ADAPTER**

NO OVERFLOW DRAIN:

4" OUTLET #T-6004
(BASE: 20" x 20")

WITH OVERFLOW DRAIN:

4" OUTLET #T-6104
(BASE: 20" x 27")

CAN BE REDUCED TO 2" OR 3"

DECK DRAINS



COPPER

USE RUBBER FLEX COUPLING
ON DRAIN OUTLET (PAGE 144)

OUTLET BASE

2" 9" #T-0210
3" 10" #T-0211



**PLASTIC
(ABS)**

**GLUED OUTLET
9-1/2" BASE**

2" #T-0200
3" #T-0202

GREASE INTERCEPTOR



J.R. SMITH

FOR RESTAURANT APPLICATIONS
3" INLET/OUTLET

GREASE CAPACITY	GPM FLOW RATE	
50#	25	#8025
100#	50	#8050

OTHER SIZES TO CHOOSE FROM.
SPECIFY GREASE CAPACITY/ LBS

www.jrsmith.com

HAIR AND LINT INTERCEPTOR

J.R. SMITH



CAST IRON

1-1/2" #8750-15

ALLOW 7" BELOW
INTERCEPTOR FOR REMOVAL
OF BASKET

SOLIDS INTERCEPTOR

J.R. SMITH



CAST IRON

1-1/2" #8710T-15
2" #8710T-20

ALLOW 9-1/2" ABOVE
INTERCEPTOR FOR
REMOVAL OF STRAINER

DRAIN PARTS



SNAP-IN STRAINER

STAINLESS STEEL

FITS

<u>INSIDE</u>	<u>O.D.</u>	
2" PIPE	3"	#ABA2463
3" PIPE	4"	#ABA2464
4" PIPE	5"	#ABA2465



3-1/4" DRAIN GRID ONLY

STAINLESS STEEL
WITH SCREW HOLES #ABA7120



SURE-FIT GASKET ONLY

#ABA2400



GENERAL PURPOSE DRAINS, PLASTIC

FITS

2" & 3" PVC PIPE	#ABA3000
3" & 4" PVC PIPE	#ABA3015
2" & 3" ABS PIPE	#ABA3001
3" & 4" ABS PIPE	#ABA3016



FLOOR SINK

SEE
PAGE 189

DRAIN BOX, CONCRETE



NON-TRAFFIC RATED
CONCRETE BOX WITH GRATE

GRATE SIZE	BOX O.D.	
8"	10"	#DBCNT80
10"	12"	#DBCNT100
12"	16"	#DBCNT120
16"	21"	#DBCNT160
24"	30"	#DBCNT240

OTHER DRAIN BOX INFO:

HEIGHT	WEIGHT	KNOCKOUTS
9"	36#	3" & 4"
11"	77#	4"
16"	135#	4"
16"	375#	4" & 6"
26"	1280#	4" - 6" - 8"

IRON GRATE

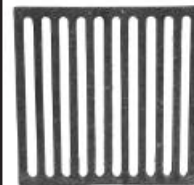

NON-TRAFFIC RATED

GRATE SIZE	THICK-NESS (PROX)	
8" x 8"	3/4"	#DBGONT80
10" x 10"	7/8"	#DBGONT100
12" x 12"	3/4"	#DBGONT120
16" x 16"	3/4"	#DBGONT160
24" x 24"	7/8"	#DBGONT240

OTHER GRATES AVAILABLE

SPECIFY OUTSIDE
DIMENSIONS & THICKNESS

**VALVE BOX,
CONCRETE**

**TRIANGLE
CONCRETE
BOX**

13-3/4"



BOX WITH CAST IRON LID:

"WATER" #CTB3
"SEWER" #CTB4

LIDS ONLY: (TRIANGLE)

"WATER" #CTB13
"SEWER" #CTB14

**VALVE BOX,
PLASTIC**



RECTANGULAR

12" x 17" #PVB1217
14" x 20" #PVB1420

(6" EXTENSION AVAILABLE)

**ROUND
PLASTIC
BOX**



6" ROUND #PVB60

**ROUND
PLASTIC
BOX**



10" ROUND #PVB10

**VALVE BOX,
CONCRETE**



RECTANGULAR
16" x 23"

BOX WITH CONCRETE LID:

"WATER" #CREB7
"SEWER" #CREB8

BOX WITH CAST IRON LID:

"WATER" #CREB3
"SEWER" #CREB4

LIDS ONLY: (11-1/4" x 18")

CONCRETE-"WATER" #CREB16
CONCRETE-"SEWER" #CREB17

CAST IRON-"WATER" #CREB13
CAST IRON-"SEWER" #CREB14

NYLON TIES



100 PIECES PER BAG

	<u>WHITE</u>	<u>BLACK</u>
4"	#DT4	#DT4B
7"	#DT6	#DT6B
11"	#DT11	#DT11B
14"	#DT14	#DT14B

450 PIECE MIX: (4" - 7" - 11")

WHITE #450
BLACK #450B

MOUNTING BASE:

WHITE 100/BAG #DT75S
BLACK 100/BAG #DT75SB

**VALVE BOX,
CONCRETE**



**ROUND
CONCRETE
BOX**

10-1/2"

BOX WITH CONCRETE LID:

"WATER" #CRB7
"SEWER" #CRB8

BOX WITH CAST IRON LID:

"WATER" #CRB3
"SEWER" #CRB4

LIDS ONLY: (7-1/4")

CONCRETE-"WATER" #CRB16
CONCRETE-"SEWER" #CRB17

CAST IRON-"WATER" #CRB13
CAST IRON-"SEWER" #CRB14

TIE DOWN STRAPS



RUBBER

20" LONG #4905
31" LONG #4907

STRAP-IT



WITH METAL GRIPPER

2'	#RED
4'	#YELLOW
6'	#GREEN
8'	#PURPLE
10'	#BLUE
12'	#BLACK

**WATER FILTER,
IN-LINE**



1/4" COMPRESSION ENDS,
BASIC UNIT
#T10

1/4" COMPRESSION ENDS,
SCALE & LIME INHIBITOR
#T10P

1/4" COMPRESSION ENDS,
HEAVY DUTY, HIGH VOLUME
#F7F28C

3/8" COMPRESSION ENDS,
HEAVY DUTY, HIGH VOLUME
#F7F38C

**EVER PURE
WATER FILTER**

**COMPLETE
UNITS**



#9272-00
(BH SYSTEM)

#H-104

#H-300

REPLACEMENT CARTRIDGES:

- #BH-CART
- #C-104
- #C-300

**WATER
DISPENSER
FAUCETS**



SEE PAGE 168

WATER FILTERS



HOUSING WITH
PRESSURE RELIEF BUTTON
(CARTRIDGE SOLD SEPARATELY)

STANDARD HOUSING

FEMALE

<u>INLET</u>	<u>COLOR</u>	
3/8"	BLUE	#AME3
3/4"	BLUE	#AME4
3/4"	CLEAR	#AME6
1"	BLUE	#AME7
1-1/2"	BLUE	#AME8

20" LONG HOUSING

FEMALE

<u>INLET</u>	<u>COLOR</u>	
3/4"	BLUE	#AME207
1"	BLUE	#AME2010
1-1/2"	BLUE	#AME2015

HOUSING O-RINGS IN STOCK

MOUNTING BRACKET



FITS:

3/8"	HOUSING	#AME24
3/4"	HOUSING	#AME25
1" & 1-1/2"	HOUSING	#AME26

FILTER CARTRIDGES



2-1/2" x 4-7/8"

2-1/2" x 9-3/4"

**ACTIVATED CARBON
5 MICRON
TASTE, ODOR & SEDIMENT**

FITS HOUSING:

3/8"	STANDARD	#AME11
3/4"	STANDARD	#AME12
3/4"	20" LONG	#AME13



2-1/2"x4-7/8"

2-1/2"x9-3/4"

4-1/2"x9-3/4"

**PLEATED
30 MICRON
TO REMOVE SEDIMENT**

FITS HOUSING:

3/8"	STANDARD	#AME17
3/4"	STANDARD	#AME18
1" & 1-1/2"	STANDARD	#AME19

3/4"	20" LONG	#AME20
1" & 1-1/2"	20" LONG	#AME21

**FILTER HOUSING
WRENCH**



FITS HOUSING:

3/4"	#AME30
1" & 1-1/2"	#AME31

**HOSE BIBBS, BRASS
LOOSE KEY**

**LOOSE
KEY,
FLANGED**



1/2" FEMALE #255LK
3/4" FEMALE #355LK

SATIN FINISH:

1/2" FEMALE #255LKSAT
3/4" FEMALE #355LKSAT

**LOOSE
KEY
HOSE BIBB**



1/2" MALE #251LK
3/4" MALE #351LK

1/2" FEMALE #253LK
3/4" FEMALE #353LK

**LOOSE
KEY
GARDEN
VALVE**



3/4" FEMALE #925LK
1" FEMALE #930LK

HOSE BIBB KEY



FOUR WAY KEY #1701
5/16" ONLY #1700

HOSE BIBBS, BRASS



STANDARD

1/2" MALE #251
3/4" MALE #351

1/2" FEMALE #253
3/4" FEMALE #353



BALL VALVE STYLE

1/2" MALE #251BV
3/4" MALE #351BV

1/2" FEMALE #253BV
3/4" FEMALE #353BV



**SWEAT
HOSE
BIBB**

STANDARD

1/2" & 3/4" SWEAT #252CC



**SWEAT
HOSE
BIBB**

BALL VALVE STYLE

1/2" & 3/4" SWEAT #252CCBV

HOSE BIBBS, BRASS



**GARDEN
VALVE**

3/4" FEMALE #925
1" FEMALE #ARR930



**FLANGED
HOSE
BIBB**

1/2" FEMALE #255
3/4" FEMALE #355

SATIN FINISH:

1/2" FEMALE #255SAT
3/4" FEMALE #355SAT



**COMPRESSION
HOSE
BIBB**

FITS 1/2" COPPER #254CC

**HOSE BIBB
VACUUM BREAKER**

FITS HOSE BIBB OUTLET



ROUGH BRASS #58ABP-B
SATIN FINISH #58ABP-SAT

**HOSE BIBBS, BRASS
CHROME PLATED**

**CHICAGO
FLANGED
HOSE
BIBB**



CHROME PLATED:

- 1/2" FEMALE #293CP
- 3/4" FEMALE #387CP

FOR SATIN FINISH,
SEE PREVIOUS PAGE

PLASTIC HOSE BIBB

**SUITABLE
FOR D.I.
WATER**



- 1/2" MALE #HBM-500T
- 3/4" MALE #HBM-750T

**WASHING MACHINE
PARTS**



SEE PAGE 166

GARDEN HOSE



**HIGH
QUALITY**

- 5/8" x 50' #GH5850
- 5/8" x 75' #GH5875
- 3/4" x 75' #GH775

GARDEN HOSE WASHER



WASHER ONLY:

- 10 PACK #986380
- INDIVIDUAL #6380

WASHER WITH SCREEN:

- 4 PACK #989914

**HOSE BIBB
LOCKING CAP**



**FITS HOSE
BIBB OUTLET**

- LOCK & KEY #21540

**HOSE & SUPPLY
BOXES**



**ACORN
RECESSED
HOSE
BOX**

- #ACO8103
SINGLE TEMP BOX WITH
DOOR AND FRAME

VACUUM BREAKER SOLD
SEPARATELY: #58ABP-SAT

SHUT-OFF CARTRIDGE:
(SCREWDRIVER)
#0528-000-002

ON/OFF CARTRIDGE:
(LOOSE KEY)
#0525-000-002

ON/OFF WHEEL HANDLE:
#0540-003-000

www.acomeng.com



**ACORN
FLANGED
HOSE
BIBB**

- ROUGH CHROME
- 3/4" FEMALE #ACO8120
- CARTRIDGE ONLY #0525-000-002



**WOODFORD
RECESSED
HOSE
BOX**

- #B24
SINGLE TEMP BOX WITH
DOOR AND FRAME



**CAN'T FIND IT?
GIVE US A
CALL**

(714) 241-7050

GARDEN HOSE FITTINGS (BRASS)

MHT = MALE HOSE THREAD
FHT = FEMALE HOSE THREAD

MIP = MALE PIPE THREAD
FIP = FEMALE PIPE THREAD

MALE x FEMALE



<u>MHT</u>	<u>FIP</u>	
3/4" x	3/4"	#GHMF7
3/4" x	1/2"	#GHMF75

FEMALE x MALE



<u>FHT</u>	<u>MIP</u>	
3/4" x	3/4"	#GHFM7
3/4" x	1/2"	#GHFM75

MALE x MALE



<u>MHT</u>	<u>MHT</u>	
3/4" x	3/4"	#GHM7

GARDEN HOSE ADAPTER

FITS STANDARD FAUCET SPOUT (15/16")



#986372

GARDEN HOSE FITTINGS (BRASS)

MHT = MALE HOSE THREAD
FHT = FEMALE HOSE THREAD

MIP = MALE PIPE THREAD
FIP = FEMALE PIPE THREAD

MALE x MALE



<u>MHT</u>	<u>MIP</u>	
3/4" x	3/4"	#GHMM7
3/4" x	1/2"	#GHMM75*

* ALSO SWEATS TO 1/2" COPPER TUBE

FEMALE x FEMALE, SWIVEL



<u>FHT</u>	<u>FIP</u>	
3/4" x	3/4"	#GHFF7
3/4" x	1/2"	#GHFF75

FEMALE x FEMALE, SWIVEL



<u>FHT</u>	<u>FHT</u>	
3/4" x	3/4"	#GHFFS7

HOSE CAP



<u>FHT</u>	
3/4"	#GHCA7

GARDEN HOSE WASHER



10 PACK	#986380
INDIVIDUAL	#6380

GARDEN HOSE BARBED ADAPTERS (BRASS)

BARB x FEMALE, SWIVEL



HOSE		
<u>I.D.</u>	<u>FHT</u>	
1/2" x	3/4"	#BRBFH57
5/8" x	3/4"	#BRBFH587
3/4" x	3/4"	#BRBFH7

BARB x MALE



HOSE		
<u>I.D.</u>	<u>MHT</u>	
1/2" x	3/4"	#BRBMH57
5/8" x	3/4"	#BRBMH587
3/4" x	3/4"	#BRBMH7

DISHWASHER HOSE CONNECTOR



90°
#DWC93

3/8" COMPRESSION x FHT



WORM GEAR HOSE CLAMP

SEE PAGE 131

**FOG NOZZLE
THERMOPLASTIC**



FEMALE INLET
3/4" GARDEN HOSE THREAD
#FNB-75GHT
1-1/2" NST FIRE HOSE THREAD
#FNB-150NST
1-1/2" FEMALE PIPE THREAD
#FNB-150S

**RAIN BIRD
QUICK COUPLER**

3/4" VALVE
#33DRC



1" VALVE
#44RC

(1" NELSON VALVE: #MIS7642)

3/4" KEY
#33DK



1" KEY
#44K

(1" NELSON KEY: #MIS7640)

3/4" 90°
#SHO



1" 90°
#SH1

SWIVEL

(1" FITS NELSON KEY)

**GARDEN HOSE
WATER NOZZLES**



PISTOL
GRIP,
INSULATED

YELLOW HANDLE #SN75



PISTOL
GRIP,
STANDARD

#CSN75



ADJUSTABLE
TWIST
NOZZLE

BRASS #BTN75



BRASS

2" LONG #PSN76



BRASS

6" LONG #BN6



ALUMINUM
ROTO-FLOW
NOZZLE

#900SK01

**GARDEN HOSE
SHUT-OFF VALVES**



SINGLE
SHUT-OFF

#GHV



DOUBLE
SHUT-OFF

#GHYV

**GARDEN HOSE
DOUBLE OUTLET**



#GHY

**GARDEN HOSE
QUICK COUPLER**



BRASS

#DGH7

PUSH-PULL RING FOR
QUICK HOSE ATTACHMENTS

SPRINKLER KEY



30" LONG

#MIS3030

WASHING MACHINE VALVES, 1/4 TURN

1/4
TURN
ON-OFF



1/2" COMPRESSION INLET
#P06320

1/2" FEMALE INLET
#V107A

WASHING MACHINE VALVES

1/2"
COMPRESSION
INLET



#221CC

1/2" FIP,
FRONT
HANDLE



#247

1/2" FIP,
TOP
HANDLE



#249

WASHING MACHINE VALVE ONLY

BRASS
BODY



#2M2

SINGLE LEVER CONTROLS
BOTH HOT & COLD WATER
SIMULTANEOUSLY

WASHING MACHINE HOSE



STAINLESS
STEEL

5' LONG #BL1260WA

WASHING MACHINE OUTLET BOXES



2 VALVES
#OB-201



SINGLE
VALVE
#OB-403

WATER HAMMER ARRESTOR, MINI



3/4"

INLET: FHT
OUTLET: MHT

#P06399C

FOR USE WITH OUTLET BOX.

GAS FLEX CONNECTOR (FOR DRYERS)



3/8" x 36" #GFC336
3/8" x 48" #GFC348

DRYER DUCT HOSE & VENT HOOD



KIT INCLUDES 5' VINYL DUCT,
VENT HOOD & CLAMPS
#1718-HK

20' HOSE ONLY: #1720
HOSE CLAMP ONLY: #HC64

NATURAL GAS OUTLET BOX



1/2"
OUTLET

#GSB-101

ICE MAKER OUTLET BOX



1/4"
OUTLET

#OB-801



ICE
MAKER
KIT

1/4" x 25'

PLASTIC TUBE #86045
COPPER TUBE #86049

